



**A Modular Double-Wall Positive
Pressure Chimney System. Factory
Built for Boiler Breeching, Engine
Exhaust, and Chimney Stack.
Grease Duct (DIS only)**

DuraStack[®]

DuraVent[®]

Specifications

Applications

DuraStack is a modular double-wall positive pressure chimney designed for use with boiler breeching and stack, engine exhaust and grease duct (DIS only).

Materials and Construction

5" - 12":

.035" stainless steel 304 or 316 inner wall. .018" stainless steel 304, 316 or galvalume steel outer wall. Laser weld exterior and interior joint.

14" - 24":

.035" stainless steel 304 or 316 inner wall. .018" stainless steel 304, 316 or galvalume steel outer wall. Pittsburgh lock exterior joint and plasma weld interior joint.

26" - 36":

.035" stainless steel 304 or 316 inner wall. .024" stainless steel 304, 316, or galvalume steel outer wall. Pittsburgh lock exterior joint and plasma weld interior joint.

DIS offers double-wall, 2" insulated chimney.
DAS offers a 2" air insulated product.

Clearances

DIS: 1" for building heating appliance chimney and 1400°F factory-built chimney and 2" for restaurant grease duct.

DAS: 4" for building heating appliance chimney and 1400°F factory-built chimney.

Diameters

5" - 36"

Listings

Tested in accordance with UL 103, UL 1978 (DIS only), ULC/ORD C959, ULC S604, NFPA211, NFPA31, NFPA37, NFPA96, CSA-B149



UL 103, UL 1978 (DIS), ULC/ORD C959 and ULC S604 System

DuraStack®

The DuraStack DIS and DAS venting systems are designed to offer the ultimate in installation convenience and versatility for a variety of applications. Certified for commercial chimney, grease duct (DIS only) and diesel exhaust applications. Thick-gauge material for the inner pipe and coupling provides a strong and rigid assembly. Self-centering flue design significantly simplifies and accelerates the installation process. Coupling configuration (patent pending) requires only one locking band and the use of a regular, less expensive, high-temperature silicone sealant.

The DIS is lined with the highest-quality insulation, densely packed to ensure low heat loss, maximum draft and a 1" clearance to combustible materials.



Typical Installations

Installation Key			
1	Flip Top	12	Adjustable Length
2	Anchor Plate Ventilated	13	Drain Tee Cap
3	Bellow Joint	14	Increaser
4	Wall Guide	15	Wall Firestop
5	Wall Support	16	45° Tee
6	Suspension Band	17	Tee Cap
7	Fixed Support	18	Length
8	Relief Valve	19	Locking Band
9	Variable Length	20	45° Elbow
10	Starting Adapter	21	12" Length
11	Finishing Cone		

• Refer to our Typical Venting Installation drawings to select the appropriate component parts for your installation.

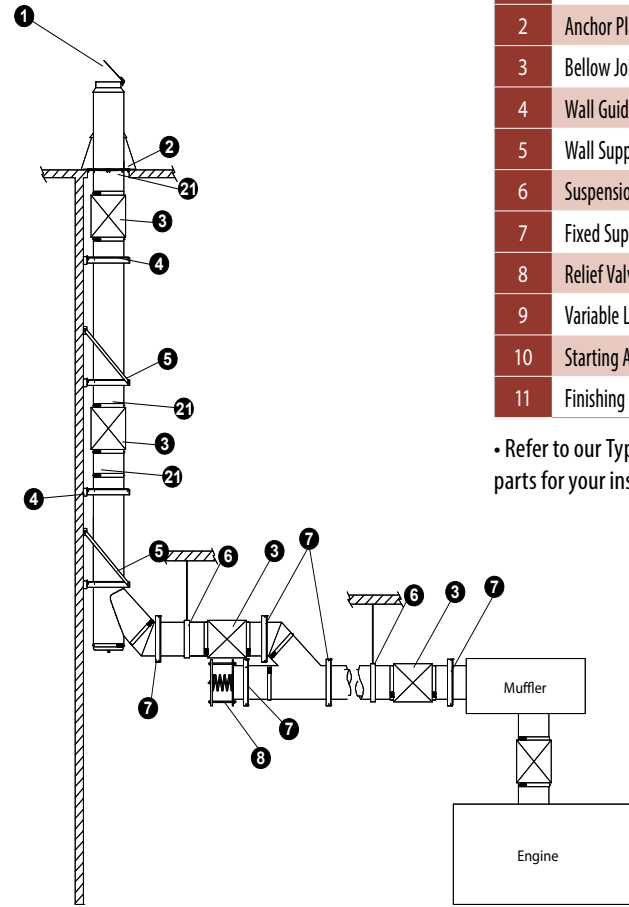

Diesel Application

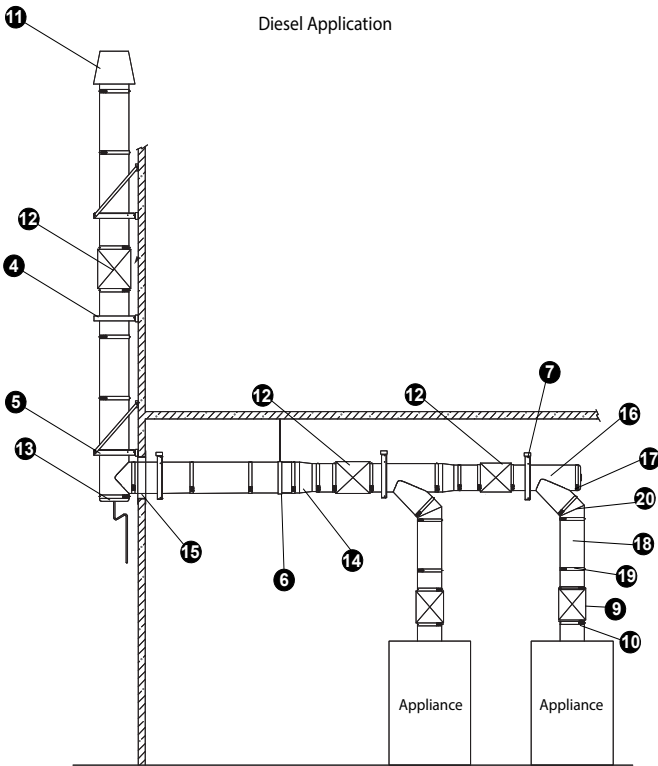

Boiler Application

Ordering Details

When placing your order, please be sure to include the desired diameter and appropriate material code within the Order Number.

For example, if you will be ordering a 12" Length for DIS (DISL12) and want to order it with 5" inner diameter (5) , Stainless 316 inner (B) and Stainless 304 outer (C), you would add 5" after DIS and add BC to the end of the Order Number: DIS5L12BC.

Products that are galvanized do not require any material indicator at the end of the Order #. For example, Our Anchor Plate is galvanized. To order an Anchor Plate, simply place your order for DIS0APF. No material code is necessary at the end.

Please be sure to note the inner material code is listed first, and the outer material code is listed last.

Available Materials are placed within the description of each product.

Coding Logic

The following examples of our coding system should make it easier for you to identify or order product.

Material Code Definitions		
B	C	E
Stainless 316	Stainless 304	Alu-Zinc Coating (Galvalume)
Coding Example		
DAS24T90BC	DIS18LBBB	DAS22DTCBE
DAS Model	DIS Model	DAS Model
24" Inside Diameter	18" Inside Diameter	22" Inside Diameter
T90 = 90° Tee	LB = Bellow Length	DTC = Drain Tee Cap
BC = 316/304 Inner/Outer Material	BB = 316/316 Inner/Outer Material	BE = 316/Galvalume Inner/Outer Material

Length



Available in sizes from 5- to 36-inch diameters, the DIS line offers double-wall, 2-inch insulated chimneys, and the DAS offers a 2-inch air insulated product.

Available Material: CC, CE, BC, BB, BE (See Ordering Details and Coding Logic for further information)

SIZE	LENGTH	12"	18"	24"	36"
Ø 5" - 36"	Effective Length	11 3/8"	17 3/8"	23 3/8"	35 3/8"
	DIS	DIS0L12	DIS0L18	DIS0L24	DIS0L36
	DAS	DAS0L12	DAS0L18	DAS0L24	DAS0L36

Adjustable Length

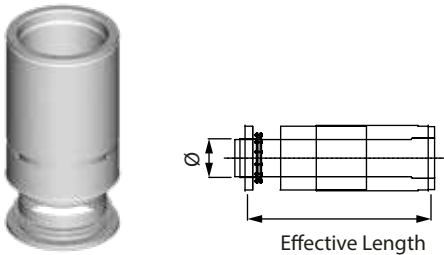

Used to add length. Adjust to fit odd dimensions and compensate for thermal expansion. Suitable for application on a low positive pressure system with less than 1" water column. Locking band included.

Available Material: CC, CE, BC, BB, BE (See Ordering Details and Coding Logic for further information)

SIZE	PRODUCT LINE	ORDER #	EFFECTIVE LENGTH
Ø 5" - 36"	DIS	DIS0LA	8"-24"
	DAS	DAS0LA	8"-24"

Variable Length

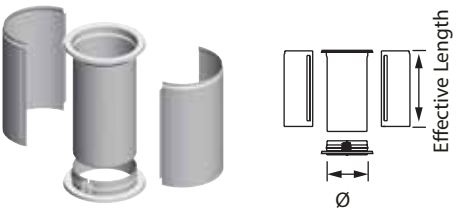

Used to adjust to fit odd dimensions. Not used for thermal expansion. Can be used in positive pressure applications. Locking band included.

Available Material: CC, CE, BC, BB, BE (See Ordering Details and Coding Logic for further information)

SIZE	PRODUCT LINE	ORDER #	EFFECTIVE LENGTH
Ø 5" - 36"	DIS	DIS0LV	4"-26"
	DAS	DAS0LV	4"-26"

Bellows Length

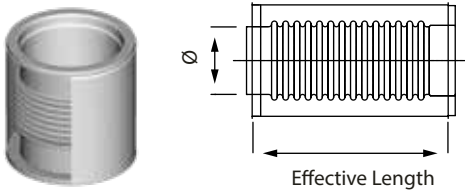

Use to compensate for thermal expansion and to minimize vibration. For diameters larger than 24" the part will require special ordering and additional lead time will apply. Has a 3" maximum compression. Locking band and liner included.

Available Material: CC, CE, BC, BB, BE (See Ordering Details and Coding Logic for further information)

SIZE	PRODUCT LINE	ORDER #	EFFECTIVE LENGTH
0 5" - 36"	DIS	DIS0LB	17 3/8"
	DAS	DAS0LB	17 3/8"

Drain Length

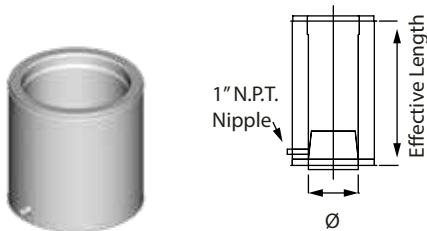

Use to drain rainwater or condensation from inner wall. Locking band included.

Available Material: CC, CE, BC, BB, BE (See Ordering Details and Coding Logic for further information)

SIZE	PRODUCT LINE	ORDER #	EFFECTIVE LENGTH
0 5" - 36"	DIS	DIS0DL	17 3/8"
	DAS	DAS0DL	17 3/8"

Horizontal Drain Length

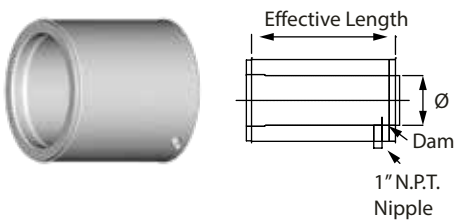

Use as a horizontal drain in grease duct applications. Locking band included.

Available Material: CC, CE, BC, BB, BE (See Ordering Details and Coding Logic for further information)

SIZE	PRODUCT LINE	ORDER #	EFFECTIVE LENGTH
0 5" - 36"	DIS	DIS0HDL	17 3/8"
	DAS	DAS0HDL	17 3/8"

Nozzle Length

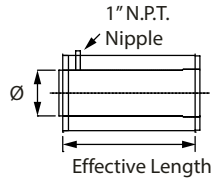

Use to insert a fire-suppression or wash-down nozzle in DIS grease duct applications. Use as a test port in DIS/DAS applications. Locking band included.

Available Material: CC, CE, BC, BB, BE (See Ordering Details and Coding Logic for further information)

SIZE	PRODUCT LINE	ORDER #	EFFECTIVE LENGTH
0 5" - 36"	DIS	DIS0NL	17 3/8"
	DAS	DAS0NL	17 3/8"

Anchor Plate Length

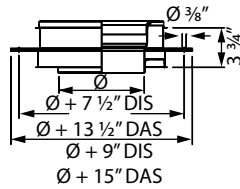

Provides maximal support to vertical sections.

Available Material: CC, BB (See Ordering Details and Coding Logic for further information)

SIZE	PRODUCT LINE	ORDER #
0 5" - 36"	DIS	DIS0APL
	DAS	DAS0APL

3° Elbows



Use to change direction of the stack or to provide offset. 3° elbows provide a minimum slope for horizontal run. Locking band included. Comes in pairs. Effective Length 17 3/8".

Available Material: CC, CE, BC, BB, BE (See Ordering Details and Coding Logic for further information)

SIZE	ANGLE	OFFSET (in.)	HEIGHT (in.)	DIS	DAS	SIZE	ANGLE	OFFSET (in.)	HEIGHT (in.)	DIS	DAS
				ORDER #						Order #	
5"	3°	N/A	3 19/32	DIS5E3	DAS5E3	20"	3°	N/A	4	DIS20E3	DAS20E3
6"	3°	N/A	3 5/8	DIS6E3	DAS6E3	22"	3°	N/A	4 1/16	DIS22E3	DAS22E3
8"	3°	N/A	3 11/16	DIS8E3	DAS8E3	24"	3°	N/A	4 3/32	DIS24E3	DAS24E3
10"	3°	N/A	3 3/4	DIS10E3	DAS10E3	26"	3°	N/A	4 5/32	DIS26E3	DAS26E3
12"	3°	N/A	3 25/32	DIS12E3	DAS12E3	28"	3°	N/A	4 7/32	DIS28E3	DAS28E3
14"	3°	N/A	3 27/32	DIS14E3	DAS14E3	30"	3°	N/A	4 1/4	DIS30E3	DAS30E3
16"	3°	N/A	3 29/32	DIS16E3	DAS16E3	32"	3°	N/A	4 5/16	DIS32E3	DAS32E3
18"	3°	N/A	3 15/16	DIS18E3	DAS18E3	34"	3°	N/A	4 3/8	DIS34E3	DAS34E3
						36"	3°	N/A	4 13/32	DIS36E3	DAS36E3

15° Elbows

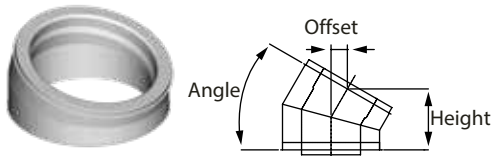

Use to change direction of the stack or to provide offset.

Available Material: CC, CE, BC, BB, BE (See Ordering Details and Coding Logic for further information)

SIZE	ANGLE	OFFSET (in.)	HEIGHT (in.)	DIS	DAS	SIZE	ANGLE	OFFSET (in.)	HEIGHT (in.)	DIS	DAS
				ORDER #						ORDER #	
5"	15°	1 ¹ / ₁₆	5 ⁷ / ₁₆	DIS5E15	DAS5E15	20"	15°	1 ⁵ / ₁₆	7 ³ / ₈	DIS20E15	DAS20E15
6"	15°	3 ⁴ / ₁₆	5 ⁹ / ₁₆	DIS6E15	DAS6E15	22"	15°	1	7 ¹¹ / ₁₆	DIS22E15	DAS22E15
8"	15°	3 ⁴ / ₁₆	5 ⁷ / ₈	DIS8E15	DAS8E15	24"	15°	1	7 ¹⁵ / ₁₆	DIS24E15	DAS24E15
10"	15°	1 ³ / ₁₆	6 ¹ / ₈	DIS10E15	DAS10E15	26"	15°	1 ¹ / ₁₆	8 ³ / ₁₆	DIS26E15	DAS26E15
12"	15°	1 ³ / ₁₆	6 ³ / ₈	DIS12E15	DAS12E15	28"	15°	1 ¹ / ₈	8 ⁷ / ₁₆	DIS28E15	DAS28E15
14"	15°	7 ⁷ / ₈	6 ⁵ / ₈	DIS14E15	DAS14E15	30"	15°	1 ¹ / ₈	8 ¹¹ / ₁₆	DIS30E15	DAS30E15
16"	15°	7 ⁷ / ₈	6 ⁷ / ₈	DIS16E15	DAS16E15	32"	15°	1 ³ / ₁₆	8 ¹⁵ / ₁₆	DIS32E15	DAS32E15
18"	15°	1 ⁵ / ₁₆	7 ¹ / ₈	DIS18E15	DAS18E15	34"	15°	1 ³ / ₁₆	9 ³ / ₁₆	DIS34E15	DAS34E15
						36"	15°	1 ¹ / ₄	9 ¹ / ₂	DIS36E15	DAS36E15

30° Elbows

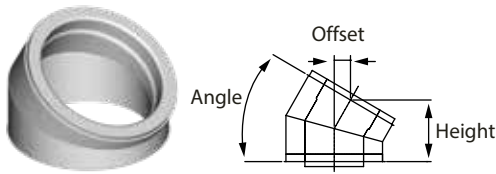

Use to change direction of the stack or to provide offset.

Available Material: CC, CE, BC, BB, BE (See Ordering Details and Coding Logic for further information)

SIZE	ANGLE	OFFSET (in.)	HEIGHT (in.)	DIS	DAS	SIZE	ANGLE	OFFSET (in.)	HEIGHT (in.)	DIS	DAS
				ORDER #						ORDER #	
5"	30°	1 ¹ / ₁₆	6 ⁵ / ₁₆	DIS5E30	DAS5E30	20"	30°	2 ¹¹ / ₁₆	10 ¹ / ₁₆	DIS20E30	DAS20E30
6"	30°	1 ³ / ₄	6 ⁹ / ₁₆	DIS6E30	DAS6E30	22"	30°	2 ¹³ / ₁₆	10 ⁹ / ₁₆	DIS22E30	DAS22E30
8"	30°	1 ⁷ / ₈	7 ¹ / ₁₆	DIS8E30	DAS8E30	24"	30°	2 ¹⁵ / ₁₆	11 ¹ / ₁₆	DIS24E30	DAS24E30
10"	30°	2	7 ⁹ / ₁₆	DIS10E30	DAS10E30	26"	30°	3 ¹ / ₁₆	11 ⁹ / ₁₆	DIS26E30	DAS26E30
12"	30°	2 ¹ / ₈	8 ¹ / ₁₆	DIS12E30	DAS12E30	28"	30°	3 ³ / ₁₆	12 ¹ / ₁₆	DIS28E30	DAS28E30
14"	30°	2 ¹ / ₄	8 ⁹ / ₁₆	DIS14E30	DAS14E30	30"	30°	3 ⁵ / ₁₆	12 ⁹ / ₁₆	DIS30E30	DAS30E30
16"	30°	2 ³ / ₈	9 ¹ / ₁₆	DIS16E30	DAS16E30	32"	30°	3 ¹ / ₂	13 ¹ / ₁₆	DIS32E30	DAS32E30
18"	30°	2 ⁹ / ₁₆	9 ⁹ / ₁₆	DIS18E30	DAS18E30	34"	30°	3 ⁵ / ₈	13 ⁹ / ₁₆	DIS34E30	DAS34E30
						36"	30°	3 ³ / ₄	14 ¹ / ₁₆	DIS36E30	DAS36E30

45° Elbows

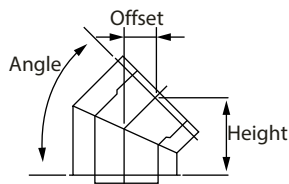

Use to change direction of the stack or to provide offset. Use two 45° elbows to create a 90° offset.

Available Material: CC, CE, BC, BB, BE (See Ordering Details and Coding Logic for further information)

SIZE	ANGLE	OFFSET (in.)	HEIGHT (in.)	DIS	DAS	SIZE	ANGLE	OFFSET (in.)	HEIGHT (in.)	DIS	DAS
				ORDER #						ORDER #	
5"	45°	2 13/16	6 15/16	DIS5E45	DAS5E45	20"	45°	5	12 13/16	DIS20E45	DAS20E45
6"	45°	2 15/16	7 1/4	DIS6E45	DAS6E45	22"	45°	5 5/16	12 15/16	DIS22E45	DAS22E45
8"	45°	3 1/4	8	DIS8E45	DAS8E45	24"	45°	5 5/8	13 3/8	DIS24E45	DAS24E45
10"	45°	3 9/16	8 11/16	DIS10E45	DAS10E45	26"	45°	5 7/8	14 5/16	DIS26E45	DAS26E45
12"	45°	3 13/16	9 3/8	DIS12E45	DAS12E45	28"	45°	6 3/16	15 1/16	DIS28E45	DAS28E45
14"	45°	4 1/8	10 1/8	DIS14E45	DAS14E45	30"	45°	6 1/2	15 3/4	DIS30E45	DAS30E45
16"	45°	4 7/16	10 13/16	DIS16E45	DAS16E45	32"	45°	6 3/4	16 7/16	DIS32E45	DAS32E45
18"	45°	4 11/16	11 1/2	DIS18E45	DAS18E45	34"	45°	7 1/16	17 3/16	DIS34E45	DAS34E45
						36"	45°	7 3/8	17 7/8	DIS36E45	DAS36E45

45° Elbow Kit

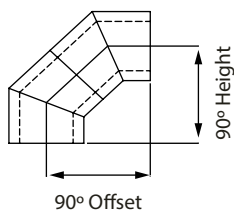

Use two 45° elbows to create a 90° offset.

Available Material: CC, CE, BC, BB, BE (See Ordering Details and Coding Logic for further information)

SIZE	ANGLE	OFFSET (in.)	HEIGHT (in.)	DIS	DAS	SIZE	ANGLE	OFFSET (in.)	HEIGHT (in.)	DIS	DAS
				ORDER #						ORDER #	
5"	90°	9 23/32	9 27/32	DIS5EK45	DAS5EK45	20"	90°	17 19/32	18 11/32	DIS20EK45	DAS20EK45
6"	90°	10 5/32	10 5/16	DIS6EK45	DAS6EK45	22"	90°	18 7/32	18 11/32	DIS22EK45	DAS22EK45
8"	90°	11 7/32	11 11/32	DIS8EK45	DAS8EK45	24"	90°	19 1/4	19 9/32	DIS24EK45	DAS24EK45
10"	90°	12 7/32	12 5/16	DIS10EK45	DAS10EK45	26"	90°	20 5/32	20 9/32	DIS26EK45	DAS26EK45
12"	90°	13 1/8	13 5/16	DIS12EK45	DAS12EK45	28"	90°	21 7/32	21 11/32	DIS28EK45	DAS28EK45
14"	90°	14 3/16	14 3/8	DIS14EK45	DAS14EK45	30"	90°	22 7/32	22 9/32	DIS30EK45	DAS30EK45
16"	90°	15 7/32	15 5/16	DIS16EK45	DAS16EK45	32"	90°	23 5/32	23 9/32	DIS32EK45	DAS32EK45
18"	90°	16 1/8	16 5/16	DIS18EK45	DAS18EK45	34"	90°	24 7/32	24 11/32	DIS34EK45	DAS34EK45
						36"	90°	25 7/32	25 5/16	DIS36EK45	DAS36EK45

90° Tees

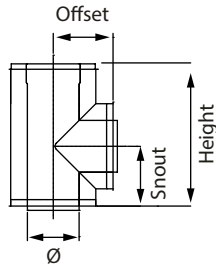

Use to change direction at 90° breaching or inspection access. Use as an inspection access in horizontal runs for grease duct applications (DIS only). Do not use in diesel/turbine applications.

Available Material: CC, CE, BC, BB, BE (See Ordering Details and Coding Logic for further information)

SIZE	ANGLE	OFFSET (in.)	HEIGHT (in.)	SNOUT (in.)	DIS	DAS	SIZE	ANGLE	OFFSET (in.)	HEIGHT (in.)	SNOUT (in.)	DIS	DAS
					ORDER #							ORDER #	
5"	90°	6 ½	15	6 ½	DIS5T90	DAS5T90	20"	90°	14	30	14	DIS20T90	DAS20T90
6"	90°	7	16	7	DIS6T90	DAS6T90	22"	90°	15	32	15	DIS22T90	DAS22T90
8"	90°	8	18	8	DIS8T90	DAS8T90	24"	90°	16	34	16	DIS24T90	DAS24T90
10"	90°	9	20	9	DIS10T90	DAS10T90	26"	90°	17	36	17	DIS26T90	DAS26T90
12"	90°	10	22	10	DIS12T90	DAS12T90	28"	90°	18	38	18	DIS28T90	DAS28T90
14"	90°	11	24	11	DIS14T90	DAS14T90	30"	90°	19	40	19	DIS30T90	DAS30T90
16"	90°	12	26	12	DIS16T90	DAS16T90	32"	90°	20	42	20	DIS32T90	DAS32T90
18"	90°	13	28	13	DIS18T90	DAS18T90	34"	90°	21	44	21	DIS34T90	DAS34T90
							36"	90°	22	46	22	DIS36T90	DAS36T90

90° Tee / Available w/ Smaller Snout



Use to change direction at 90° breaching or inspection access. Do not use in diesel/turbine applications. Available with a dam in position 1 or 2. Locking band included. Same dimensions as 90° Tees. **Available in custom size diameters.**

Available Material: CC, CE, BC, BB, BE (See Ordering Details and Coding Logic for further information)

SIZE	ANGLE	OFFSET (in.)	HEIGHT (in.)	SNOUT (in.)	DIS	DAS	SIZE	ANGLE	OFFSET (in.)	HEIGHT (in.)	SNOUT (in.)	DIS	DAS
					ORDER #							ORDER #	
5"	90°	6 ½	15	6 ½	N/A	N/A	20"	90°	14	30	14	DIS20T90B20	DAS20T90B20
6"	90°	7	16	7	DIS6T90B0	DAS6T90B0	22"	90°	15	32	15	DIS22T90B22	DAS22T90B22
8"	90°	8	18	8	DIS8T90B0	DAS8T90B0	24"	90°	16	34	16	DIS24T90B24	DAS24T90B24
10"	90°	9	20	9	DIS10T90B0	DAS10T90B0	26"	90°	17	36	17	DIS26T90B26	DAS26T90B26
12"	90°	10	22	10	DIS12T90B0	DAS12T90B0	28"	90°	18	38	18	DIS28T90B28	DAS28T90B28
14"	90°	11	24	11	DIS14T90B0	DAS14T90B0	30"	90°	19	40	19	DIS30T90B30	DAS30T90B30
16"	90°	12	26	12	DIS16T90B0	DAS16T90B0	32"	90°	20	42	20	DIS32T90B32	DAS32T90B32
18"	90°	13	28	13	DIS18T90B0	DAS18T90B0	34"	90°	21	44	21	DIS34T90B34	DAS34T90B34
							36"	90°	22	46	22	DIS36T90B36	DAS36T90B36

90° Tee w/ Dam

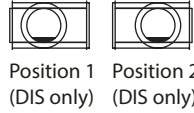

Use to change direction at 90° breaching or inspection access. Use as an inspection access in horizontal runs for grease duct applications (DIS only). Available with a dam in position 1 or 2. Locking band included. Same dimensions as 90° Tees

Available Material: CC, CE, BC, BB, BE (See Ordering Details and Coding Logic for further information)

SIZE	ANGLE	DIS	
		POSITION 1	POSITION 2
0 5" - 36"	90°	DIS0T90DP1	DIS0T90DP2

45° Tee

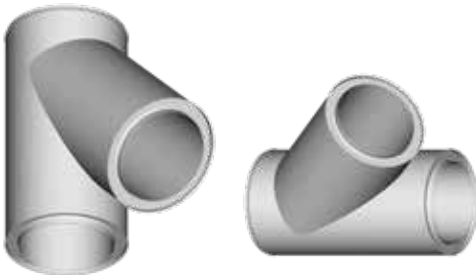

Use to change direction at 45° breaching or inspection access. Available with a smaller snout. Locking band included.

Available Material: CC, CE, BC, BB, BE (See Ordering Details and Coding Logic for further information)

SIZE	ANGLE	OFFSET (in.)	HEIGHT (in.)	SNOUT (in.)	DIS	DAS	SIZE	ANGLE	OFFSET (in.)	HEIGHT (in.)	SNOUT (in.)	DIS	DAS
					ORDER #							ORDER #	
5"	45°	10 ⁷ / ₁₆	20 ⁵ / ₁₆	4 ⁵ / ₁₆	DIS5T45	DAS5T45	20"	45°	23 ¹ / ₄	41 ⁷ / ₁₆	9 ⁵ / ₁₆	DIS20T45	DAS20T45
6"	45°	11 ⁵ / ₁₆	22 ¹ / ₁₆	4 ¹¹ / ₁₆	DIS6T45	DAS6T45	22"	45°	24 ¹⁵ / ₁₆	44 ¹¹ / ₁₆	10 ⁵ / ₁₆	DIS22T45	DAS22T45
8"	45°	13	24 ⁷ / ₈	5 ³ / ₈	DIS8T45	DAS8T45	24"	45°	26 ¹ / ₁₆	47 ¹ / ₂	11 ¹ / ₁₆	DIS24T45	DAS24T45
10"	45°	14 ³ / ₄	27 ¹¹ / ₁₆	6 ¹ / ₈	DIS10T45	DAS10T45	26"	45°	28 ³ / ₈	50 ³ / ₁₆	11 ³ / ₄	DIS26T45	DAS26T45
12"	45°	16 ⁷ / ₁₆	30 ⁹ / ₁₆	6 ¹³ / ₁₆	DIS12T45	DAS12T45	28"	45°	30 ¹ / ₁₆	53 ³ / ₁₆	12 ⁷ / ₁₆	DIS28T45	DAS28T45
14"	45°	18 ¹ / ₈	33 ³ / ₈	7 ¹ / ₂	DIS14T45	DAS14T45	30"	45°	31 ¹³ / ₁₆	56	13 ³ / ₁₆	DIS30T45	DAS30T45
16"	45°	19 ⁷ / ₈	36 ³ / ₁₆	8 ¹ / ₄	DIS16T45	DAS16T45	32"	45°	33 ¹ / ₂	58 ¹³ / ₁₆	13 ⁷ / ₈	DIS32T45	DAS32T45
18"	45°	21 ⁹ / ₁₆	39	8 ¹⁵ / ₁₆	DIS18T45	DAS18T45	34"	45°	35 ³ / ₁₆	61 ⁵ / ₈	14 ⁹ / ₁₆	DIS34T45	DAS34T45
							36"	45°	36 ¹⁵ / ₁₆	64 ¹ / ₂	15 ⁵ / ₁₆	DIS36T45	DAS36T45

45° Tee w/ Smaller Snout

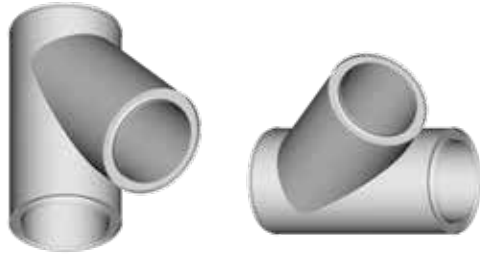

Use to change direction at 45° breaching or inspection access. Locking band included. Same dimensions as 45° tees. **Available in custom size diameters.**

Available Material: CC, CE, BC, BB, BE (See Ordering Details and Coding Logic for further information)

SIZE	ANGLE	DIS	DAS
		ORDER #	
0 5" - 36"	45°	DIS0T45B0	DAS0T45B0

45° Tee w/ Double Snout

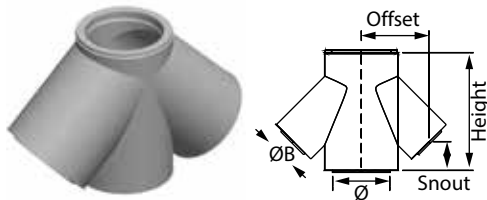

Use to change direction at 45° breaching or inspection access. Locking band included. Same dimensions as 45° tees. **Available in custom size diameters.**

Available Material: CC, CE, BC, BB, BE (See Ordering Details and Coding Logic for further information)

SIZE	ANGLE	DIS	DAS
		ORDER #	
0 5" - 36"	45°	DIS0TD45	DAS0TD45
0 5" - 36"	45°	DIS0TD45B0	DAS0TD45B0

45° Tee Relief Valve



Use to combine with the relief valve and female ANSI flange adapter. Locking band included. Same dimensions as 45° Tee.

Available Material: CC, CE, BC, BB, BE (See Ordering Details and Coding Logic for further information)

SIZE	PRODUCT LINE	ORDER #
0 5" - 36"	DIS	DIS0T45RV
	DAS	DAS0T45RV

45° Tee Y

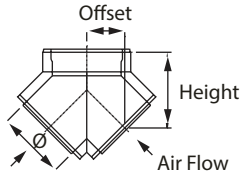

Use to provide low-pressure drop for joining appliances. Offers same diameter on all branches. Available with smaller snout. Locking band included.

Available Material: CC, CE, BC, BB, BE (See Ordering Details and Coding Logic for further information)

SIZE	ANGLE	OFFSET (in.)	HEIGHT (in.)	DIS	DAS	SIZE	ANGLE	OFFSET (in.)	HEIGHT (in.)	DIS	DAS
				ORDER #						ORDER #	
5"	5	4 9/16	10 7/16	DIS5TY	DAS5TY	20"	20	9 7/8	18 13/16	DIS20TY	DAS20TY
6"	6	4 15/16	11	DIS6TY	DAS6TY	22"	22	10 9/16	19 15/16	DIS22TY	DAS22TY
8"	8	5 5/8	12 1/8	DIS8TY	DAS8TY	24"	24	11 5/16	21 1/16	DIS24TY	DAS24TY
10"	10	6 5/16	13 3/4	DIS10TY	DAS10TY	26"	26	12	22 3/16	DIS26TY	DAS26TY
12"	12	7 1/16	14 3/8	DIS12TY	DAS12TY	28"	28	12 11/16	23 5/16	DIS28TY	DAS28TY
14"	14	7 3/4	15 1/2	DIS14TY	DAS14TY	30"	30	13 7/16	24 7/16	DIS30TY	DAS30TY
16"	16	8 7/16	16 9/16	DIS16TY	DAS16TY	32"	32	14 1/8	25 9/16	DIS32TY	DAS32TY
18"	18	9 3/16	17 11/16	DIS18TY	DAS18TY	34"	34	14 13/16	26 11/16	DIS34TY	DAS34TY
						36"	36	15 9/16	27 13/16	DIS36TY	DAS36TY

45° Tee Y w/Smaller Snout



Use to provide low-pressure drop for joining appliances. Offers same diameter on all branches. Available with smaller snout. Locking band included. Same dimensions as 45° Tee Y. **Available in custom size diameters.**

Available Material: CC, CE, BC, BB, BE (See Ordering Details and Coding Logic for further information)

SIZE	ANGLE	DIS	DAS
		ORDER #	
0 5" - 36"	45°	DIS0TY0	DAS0TY0

90° Grease Tees (DIS only)

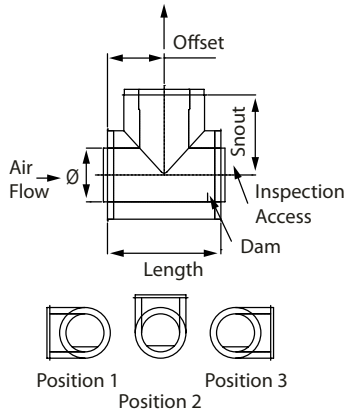

Use in grease duct applications as a horizontal-to-vertical connection with an inspection or clean-out access. Locking band included. Dam can be ordered in #1, 2 or 3 position.

Available Material: CC, CE, BC, BB, BE (See Ordering Details and Coding Logic for further information)

SIZE	OFFSET (in.)	LENGTH (in.)	SNOUT (in.)	DIS
				ORDER #
5"	6 ½	13	8 ½	DIS5GT90P#
6"	7	14	9	DIS6GT90P#
8"	8	16	10	DIS8GT90P#
10"	9	18	11	DIS10GT90P#
12"	10	20	12	DIS12GT90P#
14"	11	22	13	DIS14GT90P#
16"	12	24	14	DIS16GT90P#
18"	13	26	15	DIS18GT90P#
20"	14	28	16	DIS20GT90P#
22"	15	30	17	DIS22GT90P#
24"	16	32	18	DIS24GT90P#
26"	17	34	19	DIS26GT90P#
28"	18	36	20	DIS28GT90P#
30"	19	38	21	DIS30GT90P#
32"	20	40	22	DIS32GT90P#
34"	21	42	23	DIS34GT90P#
36"	22	44	24	DIS36GT90P#

Grease Tee Y (DIS only)

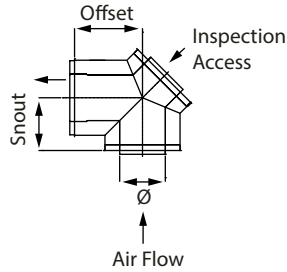

Use to provide low-pressure drop for joining appliances. Offers same diameter on all branches. Available with smaller snout. Locking band included. Locking band included.

Available Material: CC, CE, BC, BB, BE (See Ordering Details and Coding Logic for further information)

SIZE	OFFSET (in.)	SNOUT (in.)	DIS	SIZE	OFFSET (in.)	SNOUT (in.)	DIS
			ORDER #				ORDER #
5	8½	6½	DIS5GTY	22	17	15	DIS22GTY
6	9	7	DIS6GTY	24	18	16	DIS24GTY
8	10	8	DIS8GTY	26	19	17	DIS26GTY
10	11	9	DIS10GTY	28	20	18	DIS28GTY
12	12	10	DIS12GTY	30	21	19	DIS30GTY
14	13	11	DIS14GTY	32	22	20	DIS32GTY
16	14	12	DIS16GTY	34	23	21	DIS34GTY
18	15	13	DIS18GTY	36	24	22	DIS36GTY
20	16	14	DIS20GTY				

Tee Cap

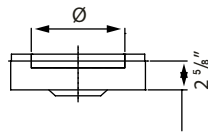

Use to close and seal unused tee ports. Locking band included.

Available Material: CC, CE, BC, BB, BE (See Ordering Details and Coding Logic for further information)

SIZE	PRODUCT LINE	ORDER #
Ø 5" - 36"	DIS	DISØTC
	DAS	DASØTC

Drain Tee Cap

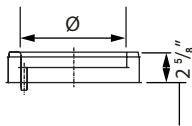

Use to close and seal unused tee ports and to provide drain point for rain or condensation. Locking band included. 1" - NPT

Available Material: CC, CE, BC, BB, BE (See Ordering Details and Coding Logic for further information)

SIZE	PRODUCT LINE	ORDER #
Ø 5" - 36"	DIS	DISØDTC
	DAS	DASØDTC

No Tool Access Door

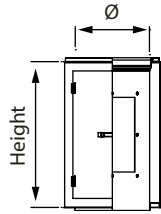

Use for inspection and cleaning. Greaseproof and fire-tight seal. Replacement gaskets available.

Available Material: CC, CE, BC, BB, BE (See Ordering Details and Coding Logic for further information)

SIZE	EFFECTIVE LENGTH	DIS
0 5" - 36"	23 3/8"	DIS0ADL24
	35 3/8"	DIS0ADL36

Locking Band

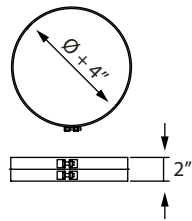

Use to clamp and seal parts together. To be sealed with outer joint sealant (not included). Included with components that require the locking band.

Available Material: Stainless 304 (C)

SIZE	PRODUCT LINE	ORDER #
0 5" - 36"	DIS	DIS0BSC

Damper Length

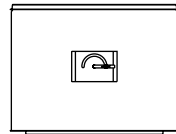

Available Material: CC, CE, BC, BB, BE (See Ordering Details and Coding Logic for further information)

SIZE	DIS	DAS	EFFECTIVE LENGTH
	ORDER #	ORDER#	
0 5"-12"	DIS5L12DAMP	DAS5L12DAMP	11 3/8"
	DIS6L12DAMP	DAS6L12DAMP	11 3/8"
	DIS8L12DAMP	DAS8L12DAMP	11 3/8"
	DIS10L12DAMP	DAS10L12DAMP	11 3/8"
	DIS12L12DAMP	DAS12L12DAMP	11 3/8"
0 14"-18"	DIS14L18DAMP	DAS14L18DAMP	17 3/8"
	DIS16L18DAMP	DAS16L18DAMP	17 3/8"
	DIS18L18DAMP	DAS18L18DAMP	17 3/8"
0 20"-24"	DIS20L24DAMP	DAS20L24DAMP	23 3/8"
	DIS22L24DAMP	DAS22L24DAMP	23 3/8"
	DIS24L24DAMP	DAS24L24DAMP	23 3/8"

Tapered Increaser

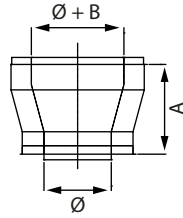

Use when a pipe diameter change is required. Locking band included.

Available Material: CC, CE, BC, BB, BE (See Ordering Details and Coding Logic for further information)

STEP	DIS	DAS	A (in.)	B (in.)
	ORDER #	ORDER#		
One 0 5"-36" Increase	DIS0TINS1	DAS0TINS1	8	2
Two 0 5"-36" Increase	DIS0TINS2	DAS0TINS2	12	4
Three 0 5"-36" Increase	DIS0TINS3	DAS0TINS3	16	6

Step Increaser

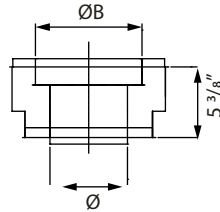

Use when a pipe diameter change is required in a small space. More restrictive than the tapered increaser. Locking band included.

Available Material: CC, CE, BC, BB, BE (See Ordering Details and Coding Logic for further information)

SIZE	Ø B (in.)	DIS	DAS	SIZE	Ø B (in.)	DIS	DAS
		ORDER #	ORDER#			ORDER #	ORDER#
5"	6	DIS5IN6	DAS5IN6	20"	22	DIS20IN22	DAS20IN22
5"	8	DIS5IN8	DAS5IN8	20"	24	DIS20IN24	DAS20IN24
6"	8	DIS6IN8	DAS6IN8	22"	24	DIS22IN24	DAS22IN24
6"	10	DIS6IN10	DAS6IN10	22"	26	DIS22IN26	DAS22IN26
8"	10	DIS8IN10	DAS8IN10	24"	26	DIS24IN26	DAS24IN26
8"	12	DIS8IN12	DAS8IN12	24"	28	DIS24IN28	DAS24IN28
10"	12	DIS10IN12	DAS10IN12	26"	28	DIS26IN28	DAS26IN28
10"	14	DIS10IN14	DAS10IN14	26"	30	DIS26IN30	DAS26IN30
12"	14	DIS12IN14	DAS12IN14	28"	30	DIS28IN30	DAS28IN30
12"	16	DIS12IN16	DAS12IN16	28"	32	DIS28IN32	DAS28IN32
14"	16	DIS14IN16	DAS14IN16	30"	32	DIS30IN32	DAS30IN32
14"	18	DIS14IN18	DAS14IN18	30"	34	DIS30IN34	DAS30IN34
16"	18	DIS16IN18	DAS16IN18	32"	34	DIS32IN34	DAS32IN34
16"	20	DIS16IN20	DAS16IN20	32"	36	DIS32IN36	DAS32IN36
18"	20	DIS18IN20	DAS18IN20	34"	36	DIS34IN36	DAS34IN36
18"	22	DIS18IN22	DAS18IN22				

ANSI Flange Adapter

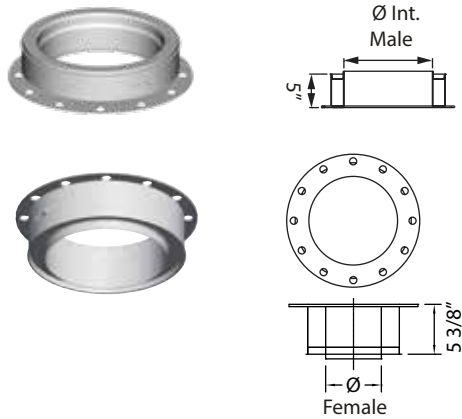

Use for connecting a 125 or 150 lb. ANSI flange. 1/4" thickness with a bolt hole pattern, bolt hole center pattern and quantity per 125-lb ANSI. Locking band included.

Available Material: CC, CE, BC, BB, BE (See Ordering Details and Coding Logic for further information)

SIZE	Ø B (in.)	MALE		FEMALE	
		DIS	DAS	DIS	DAS
		ORDER #		ORDER #	
5"	10	DIS5FA	DAS5FA	DIS5FFA	DAS5FFA
6"	11	DIS6FA	DAS6FA	DIS6FFA	DAS6FFA
8"	13½	DIS8FA	DAS8FA	DIS8FFA	DAS8FFA
10"	16	DIS10FA	DAS10FA	DIS10FFA	DAS10FFA
12"	19	DIS12FA	DAS12FA	DIS12FFA	DAS12FFA
14"	21	DIS14FA	DAS14FA	DIS14FFA	DAS14FFA
16"	23	DIS16FA	DAS16FA	DIS16FFA	DAS16FFA
18"	25	DIS18FA	DAS18FA	DIS18FFA	DAS18FFA
20"	27½	DIS20FA	DAS20FA	DIS20FFA	DAS20FFA
22"	29½	DIS22FA	DAS22FA	DIS22FFA	DAS22FFA
24"	32	DIS24FA	DAS24FA	DIS24FFA	DAS24FFA
26"	34½	DIS26FA	DAS26FA	DIS26FFA	DAS26FFA
28"	36½	DIS28FA	DAS28FA	DIS28FFA	DAS28FFA
30"	38½	DIS30FA	DAS30FA	DIS30FFA	DAS30FFA
32"	42	DIS32FA	DAS32FA	DIS32FFA	DAS32FFA
34"	44	DIS34FA	DAS34FA	DIS34FFA	DAS34FFA
36"	46	DIS26FA	DAS26FA	DIS26FFA	DAS26FFA

Single Wall Adapter

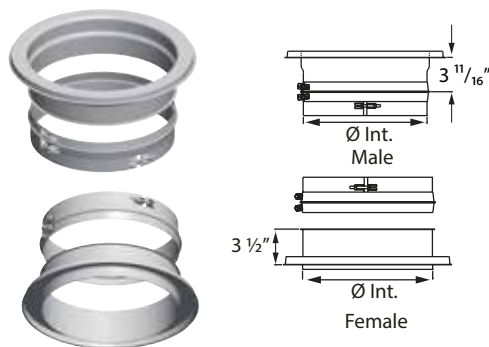

Use as a non-welded attachment for appliances having an unflanged outlet. Locking band included.

Available Material: Stainless 316 (B), Stainless 304 (C) (See Ordering Details and Coding Logic for further information)

SIZE	PRODUCT LINE	MALE	FEMALE
		ORDER #	
Ø 5" - 36"	DIS	DIS0SWA	DIS0FSWA
	DAS		

Flanged Adapter

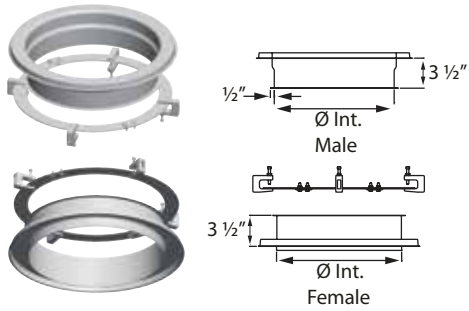

Use on standard appliances such as kitchen hood exhausts. Flanged at the end. Locking band included.

Materials available: Stainless 316 (B), Stainless 304 (C)(See Ordering Details and Coding Logic for further information)

SIZE	PRODUCT LINE	MALE	FEMALE
		ORDER #	
Ø 5" - 36"	DIS	DISØFHA	DISØFFHA
Ø 5" - 36"	DAS		

Viessmann Adapter

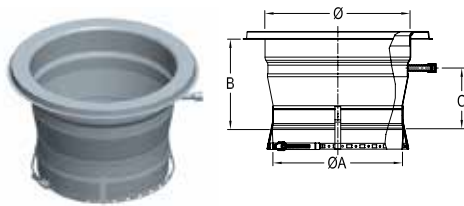

Use as a single wall starter piece for Vitorond VD2 and VD2A Viessmann appliances.

SIZE	ORDER #
Ø 8" - Ø 12"	DISØVSSVD2

Fan Adapter

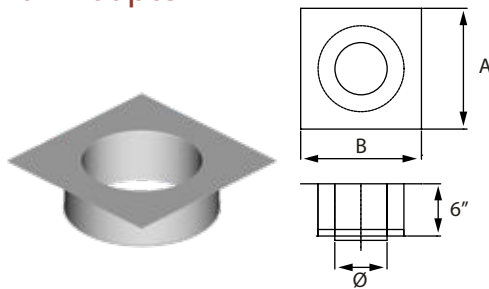

Use for connection to an "up-blast" kitchen fan.

Available Material: CC, CE, BC, BB, BE (See Ordering Details and Coding Logic for further information)

SIZE	A	B	ORDER #
Ø 5" - 36"	Custom	Custom	DISØFAN(AB)

Square to Round Adapter

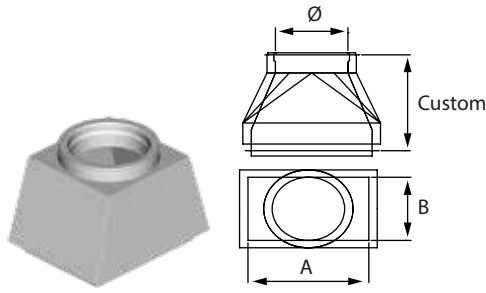

Connects to kitchen hood. Locking band included. Made to order.

Available Material: CC, CE, BC, BB, BE (See Ordering Details and Coding Logic for further information)

SIZE	A	B	PRODUCT LINE	ORDER #
Ø 5" - 36"	Custom	Custom	DIS	DISØSTR(AB)
			DAS	DASØSTR(AB)

CT to DIS/DAS Adapter

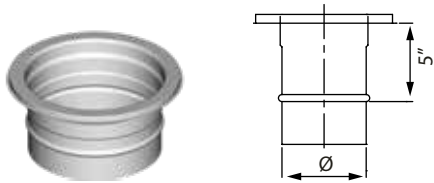

Use to connect CT model chimney liner to DIS or DAS. Locking band included.

Materials available: Stainless 316 (B), Stainless 304 (C)(See Ordering Details and Coding Logic for further information)

SIZE	ORDER #
Ø 5" - 36"	DISØRCTMB

DIS/DAS to CT Adapter

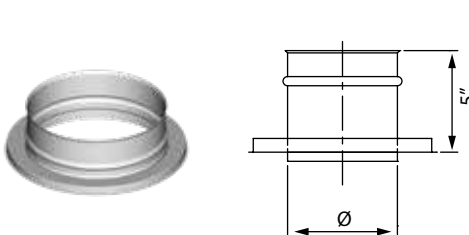

Use to connect DIS or DAS model chimney to CT chimney liner. Locking band included.

Materials available: Stainless 316 (B), Stainless 304 (C)(See Ordering Details and Coding Logic for further information)

SIZE	ORDER #
Ø 5" - 36"	DISØRCTFB

Cleaverbrooks FLX Adapter

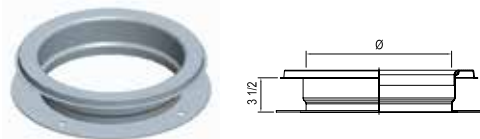

Available Material: Stainless 304 (C) (See Ordering Details and Coding Logic for further information)

SIZE	PRODUCT LINE	ORDER #
Ø 10" - 24"	DIS	DISØCBFLX

Anchor Plate

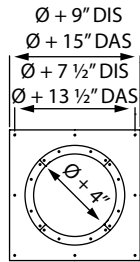

Use for supporting the stack in vertical or horizontal runs and to provide a fixed point for thermal expansion consideration. Maintains a minimum of 1" clearance to the opening on DIS installations and 4" clearance to the opening on DAS. All hardware included except connection to structure. Must not be in contact with combustible.

Available material: Stainless 439, Galvanized (See Ordering Details and Coding Logic for further information)

SIZE	PRODUCT LINE	ORDER #
0 5" - 36"	DIS	DIS0APF
	DAS	DAS0APF

Anchor Plate-Heavy Duty

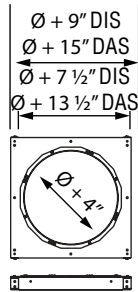
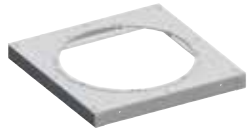

Use for supporting the stack in vertical or horizontal runs and to provide a fixed point for thermal expansion consideration. Heavy-duty steel "C" channel base - 2 1/2" x 1 1/2".

Available material: Stainless 439, Galvanized (See Ordering Details and Coding Logic for further information)

SIZE	PRODUCT LINE	ORDER #
0 5" - 36"	DIS	DIS0APHDF
	DAS	DAS0APHDF

Anchor Plate-Ventilated

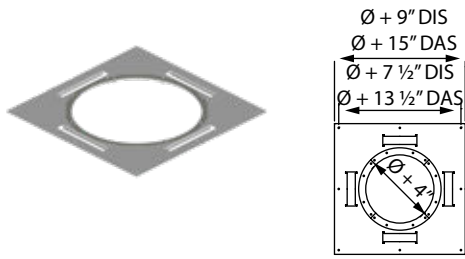

Use for supporting the stack in vertical runs in contact with combustible materials and to provide a fixed point for thermal expansion consideration. Maintains a minimum of 2" clearance to the opening on DIS and 4½" on DAS. All hardware included except connection to structure.

Available material: Stainless 439, Galvanized (See Ordering Details and Coding Logic for further information)

SIZE	PRODUCT LINE	ORDER #
0 5" - 36"	DIS	DIS0APVF
	DAS	DAS0APVF

Wall Support

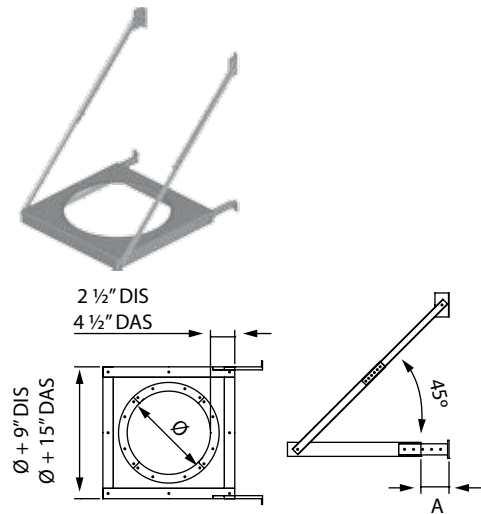

Use for supporting the stack in vertical runs in contact with combustible materials and to provide a fixed point for thermal expansion consideration. Maintains a minimum of 2½" clearance to the wall on DIS and 4½" on DAS, and up to 7½" on DIS and 9½" on DAS when wall brace is extended. All hardware included except connection at wall.

Available material: Stainless 439, Galvanized (See Ordering Details and Coding Logic for further information)

SIZE	PRODUCT LINE	ORDER #	A
0 5" - 36"	DIS	DIS0WSF	0" - 5"
	DAS	DAS0WSF	0" - 5"

Cradle Support

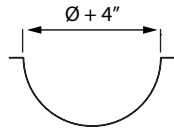

Use for supporting and guiding the stack in horizontal runs. Not recommended for thermal expansion systems. See installation instructions for spacing.

Available material: Galvalume (E) (See Ordering Details and Coding Logic for further information)

SIZE	PRODUCT LINE	ORDER #
0 5" - 36"	DIS	DISØCS
	DAS	

Suspension Band

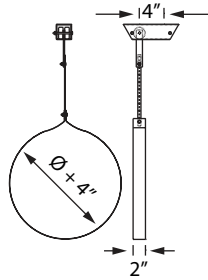

Use for supporting and guiding the stack in horizontal runs. Allows 4" of travel for thermal expansion. Rail, trolley and band included. Flexible support strap (not included) is used to join the band and the trolley-see instruction manual for required specifications. All hardware included except connection to structure.

Available material: Galvalume (E) (See Ordering Details and Coding Logic for further information)

SIZE	PRODUCT LINE	ORDER #
0 5" - 36"	DIS	DISØSB
	DAS	

Wall Guide

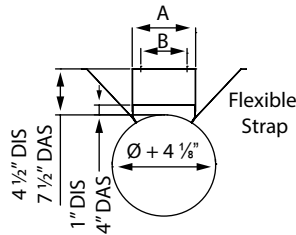

Use for guiding vertical installation attached to the wall. Maintains a minimum of 1" clearance to the wall on DIS and 4" on DAS. Extension for additional clearance of 3½" is included. All hardware included except connection to structure. Flexible strap (not included) can be used to add rigidity when using extension-see instruction manual for required specifications

Available material: Stainless 439, Galvalume (E) (See Ordering Details and Coding Logic for further information)

SIZE	Ø A (in.)	Ø B (in.)	DIS	DAS
			ORDER #	
5"	7 7/8	6 1/8	DIS5WG	DAS5WG
6"	8 9/16	6 13/16	DIS6WG	DAS6WG
8"	10	8 1/4	DIS8WG	DAS8WG
10"	11 13/32	9 21/32	DIS10WG	DAS10WG
12"	12 13/16	11 1/16	DIS12WG	DAS12WG
14"	14 7/32	12 15/32	DIS14WG	DAS14WG
16"	15 21/32	13 29/32	DIS16WG	DAS16WG
18"	17 1/16	15 5/16	DIS18WG	DAS18WG
20"	18 15/32	16 23/32	DIS20WG	DAS20WG
22"	19 7/8	18 1/8	DIS22WG	DAS22WG
24"	21 5/16	19 9/16	DIS24WG	DAS24WG
26"	22 23/32	20 31/32	DIS26WG	DAS26WG
28"	24 1/8	22 3/8	DIS28WG	DAS28WG
30"	25 17/32	23 25/32	DIS30WG	DAS30WG
32"	26 31/32	25 7/32	DIS32WG	DAS32WG
34"	28 3/8	26 5/8	DIS34WG	DAS34WG
36"	29 25/32	38 1/32	DIS36WG	DAS36WG

Floor Guide

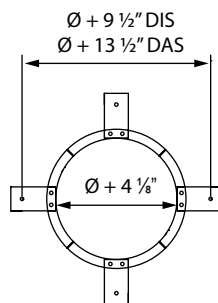

Use for guiding in vertical installation when passing through a floor or roof. Maintains a minimum of 2" clearance to the opening on DIS installations and 4" clearance to the opening on DAS. All hardware included except connection to structure.

Available material: Galvanized (See Ordering Details and Coding Logic for further information)

SIZE	PRODUCT LINE	ORDER #
Ø 5" - 36"	DIS	DISØFGF
	DAS	DASØFGF

Guy Wire

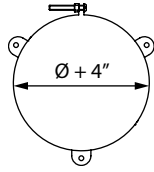

Use for guiding in vertical installation above the roof. All hardware included except wire, tensioner and connection to roof. See instruction manual for required specifications.

Available material: Galvalume (E) (See Ordering Details and Coding Logic for further information)

SIZE	PRODUCT LINE	ORDER #
0 5" - 36"	DIS	DISØGW
	DAS	

Floor / Ceiling Radiation Shield

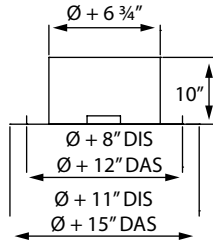

Use where chimney passes through a combustible roof or structure. Maintains a minimum of 2" clearance to the opening on DIS installations and 4" clearance to the opening on DAS.

Available material: Galvalume (E) (See Ordering Details and Coding Logic for further information)

SIZE	PRODUCT LINE	ORDER #
0 5" - 36"	DIS	DISØFS
	DAS	DASØFS

Wall Radiation Shield

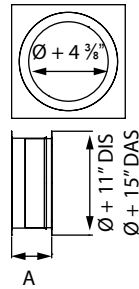
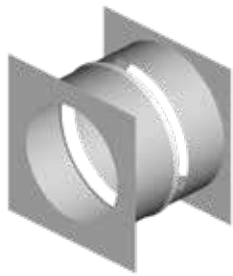

Use where chimney passes through a combustible wall. Maintains a minimum of 2" clearance to the opening on DIS installations and 4" clearance to the opening on DAS. Not listed for diameter larger than 10".

Available material: Galvalume (E) (See Ordering Details and Coding Logic for further information)

SIZE	PRODUCT LINE	ORDER #	A
Ø 5" - 36"	DIS	DISØFSW	7" - 12"
	DAS	DASØFSW	7" - 12"

No Loss Cap

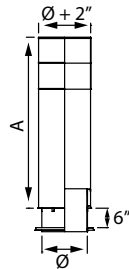

Available material: Stainless 304 (C) (See Ordering Details and Coding Logic for further information)

SIZE	Ø A (in.)	DIS	DAS
		ORDER #	
5"	19 11/16	DIS5CNL	
6"	23 11/16	DIS6CNL	
8"	31 11/16	DIS8CNL	
10"	36 7/16	DIS10CNL	
12"	48 9/16	DIS12CNL	
14"	55 9/16	DIS14CNL	
16"	64 3/16	DIS16CNL	
18"	72 3/16	DIS18CNL	
20"	72 3/16	DIS20CNL	
22"	72 3/16	DIS22CNL	
24"	72 3/16	DIS36CNL	

Roof Brace

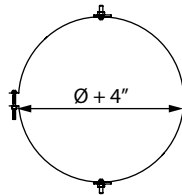

Use for bracing in vertical installation above the roof. All hardware included except brace and connection to roof.

Available material: Galvalume (E) (See Ordering Details and Coding Logic for further information)

SIZE	PRODUCT LINE	ORDER #
Ø 5" - 36"	DIS	DISØRB
	DAS	

Flashing

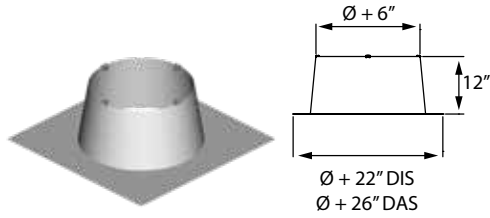

Use in conjunction with storm collar for weatherization at the roof. Storm collar included.

Materials available: Galvalume (E), Stainless 304 (C) (See Ordering Details and Coding Logic for further information)

SIZE	PRODUCT LINE	ORDER #
0 5" - 36"	DIS	DIS0F
	DAS	DAS0F

Adjustable Flashing

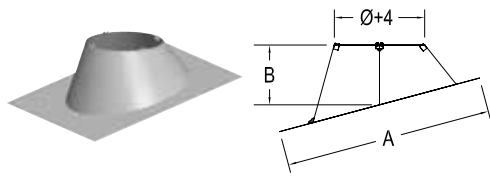

Use in conjunction with storm collar for weatherization at the roof. 5° to 30° pitch.

Materials available: Galvalume (E), Stainless 304 (C) (See Ordering Details and Coding Logic for further information)

SIZE	PRODUCT LINE	ORDER #
0 5" - 36"	DIS	DIS0F30
	DAS	DAS0F30

Storm Collar

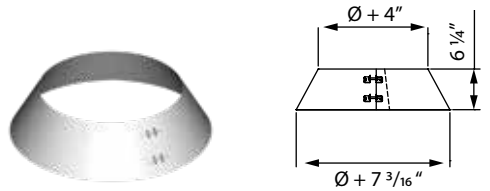

Use above the flashing for complete weatherization above the roof. To be sealed with outer joint sealant (not included).

Materials available: Galvalume (E), Stainless 304 (C) (See Ordering Details and Coding Logic for further information)

SIZE	PRODUCT LINE	ORDER #
0 5" - 36"	DIS	DIS0SC
	DAS	

Rain Cap

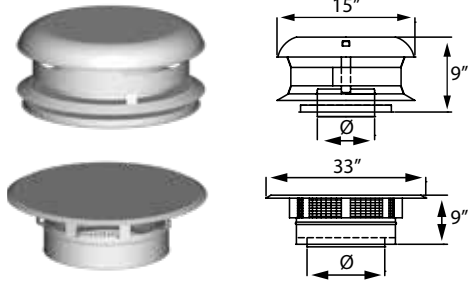

Use to provide the greatest degree of rain protection. Model 2 is available with bird screen.

Materials available: Stainless 304 (C)

SIZE	PRODUCT LINE	Model	ORDER #
Ø 5" - 10"	DIS	1	DISØRCC
	DAS		
Ø 12" - 18"	DIS	2	DISØRCC
	DAS		

Cone Cap



Materials available: Stainless 304 (C)

SIZE	A"	B"	DIS	DAS
			ORDER #	
Ø 5"	19 7/8"	12 1/2"	DIS5CRC	
Ø 6"	19 7/8"	13"	DIS6CRC	
Ø 8"	24"	15 1/4"	DIS8CRC	
Ø 10"	27 3/4"	17 1/8"	DIS10CRC	
Ø 12"	27 3/4"	17 7/8"	DIS12CRC	
Ø 14"	31 1/2"	17 7/8"	DIS14CRC	
Ø 16"	31 1/2"	18 5/8"	DIS16CRC	
Ø 18"	44"	25 3/4"	DIS18CRC	
Ø 20"	44"	26 1/8"	DIS20CRC	
Ø 22"	44"	26 3/4"	DIS22CRC	
Ø 24"	56"	31 1/2"	DIS24CRC	
Ø 26"	56"	32 1/8"	DIS26CRC	
Ø 28"	56"	31 7/8"	DIS28CRC	
Ø 30"	56"	32 1/2"	DIS30CRC	
Ø 32"	60"	33 1/8"	DIS32CRC	
Ø 34"	60"	33 1/8"	DIS34CRC	
Ø 36"	60"	33 3/4"	DIS36CRC	

Finishing Cone

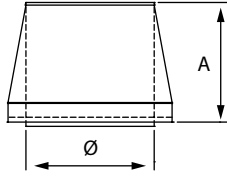

Use to provide the greatest draft. Requires a drain at bottom of stack.

Available Material: CC, CE, BC, BB, BE (See Ordering Details and Coding Logic for further information)

SIZE	PRODUCT LINE	ORDER #	A
Ø 5" - 36"	DIS	DISØFC	10"-27"
	DAS		

Flip Top

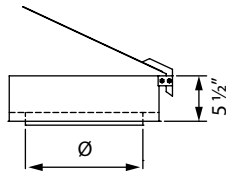

Use to prevent moisture and debris from entering system. Flip top opens with internal pressure and closes when no pressure is present. For engine exhaust application.

Materials available: Stainless 304 (C) (See Ordering Details and Coding Logic for further information)

SIZE	PRODUCT LINE	ORDER #
Ø 5" - 24"	DIS	DISØFT
	DAS	

Miter Cut

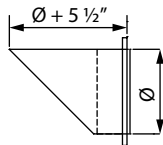

Use for horizontal engine exhaust termination.

Materials available: Stainless 304 (C) (See Ordering Details and Coding Logic for further information)

SIZE	PRODUCT LINE	ORDER #
Ø 5" - 36"	DIS	DISØMC
	DAS	

Relief Valve

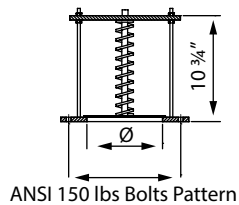
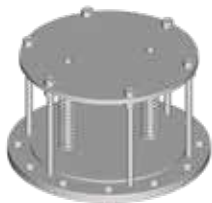

ANSI 150 lbs Bolts Pattern

Helps control the venting pressure should a backfire occur. Must be used in conjunction with ANSI flanged adapter and 45° tee relief valve. Use on engine exhaust.

Materials available: Stainless 304 (C) (See Ordering Details and Coding Logic for further information)

SIZE	PRODUCT LINE	ORDER #
Ø 5" - 24"	DIS	DISØRV
	DAS	

DURASTACK 1 YEAR STANDARD AND 15 YEAR LIMITED WARRANTY

This DuraVent 1-year Standard and 15-year Limited Warranty warrants your DuraStack® DIS and DAS stainless steel multi-fuel double-wall insulated chimney systems (Product) to be free from defects in material and workmanship at the time of manufacture. This 1-year Standard and 15-year Limited Warranty includes all components and fittings. After installation, if covered components manufactured by DuraVent are found to be defective in materials or workmanship during the 1-year Standard and 15-year Warranty period and while the Product remains at the site of the original installation, DuraVent will replace the covered components. DuraVent reserves the right to replace covered components with an equivalent product and the replacement must be carried out in accordance with DuraVent recommendations. If replacement is not commercially practical, DuraVent will, at its option, refund the purchase price or wholesale price of the DuraVent Product, whichever is applicable. Labor or freight costs to remove or replace DuraVent components are not included. THERE ARE EXCLUSIONS AND LIMITATIONS to the 1-year Standard and 15-year Limited Warranty as described herein. DuraVent Grease Duct applications are covered separately (see DuraStack – DIS Grease Duct Applications Warranty) and are not included under this warranty.

Coverage Commencement Date

Warranty coverage begins on the date of shipment from DuraVent.

Exclusions and Limitations

This 1-year Standard and 15-year Limited Warranty applies only if the Product is installed in the United States or Canada and only if used for the application for which it was designed and intended. The Product must be installed and maintained in accordance with the system design, installation and maintenance instructions for the Product and in compliance with all applicable installation and building codes and high-quality, industry-accepted trade practices. Any repaired or replaced product shall be warranted for the duration of time no longer than the remaining or unexpired term of the original warranty.

The 1-year Standard Warranty is extended to the purchaser subject to the following conditions:

- Generally accepted engineering practices have been followed to determine that sizing and material specifications are suitable for the application and environment involved;
- The components have been correctly installed in accordance with the system design and installation instructions for the Product as provided by DuraVent;
- Damage is not a result of burning garbage, waste oil, #6 oil or any other inappropriate or prohibited material in the appliance served by the venting system.

The Extended 15-year Limited Warranty is extended to the purchaser subject to the following additional conditions:

- The design parameters provided to DuraVent by the responsible engineer at the time of design were and are accurately representative of the operating conditions;
- The system sizing and design was performed or approved by DuraVent;
- The boiler or engine exhaust is and has operated free of solvent or refrigerant vapors or any halogenated compound which may cause acid condensates to form within the chimney system;
- The entire chimney or exhaust system was supplied by DuraVent;
- Exposed Galvalume and galvanized surfaces are protected with a minimum of one base coat of primer and one finish coat of heat resistant and corrosive-resistant paint at all times. Stainless steel surfaces do not require painting.

This warranty is non-transferable and extends to the original owner only. The Product must be purchased through an DuraVent Agent/Representative and proof of purchase must be provided.

DuraVent will not be responsible for: (a) damages caused by normal wear and tear, corrosion from salt air, accident, riot, fire, flood or acts of God; (b) damages caused by abuse, negligence, misuse, or unauthorized alteration or repair of the Product affecting its stability or performance; (c) damages caused by failing to provide proper maintenance and service in accordance with the design, installation and maintenance instructions for the Product; (d) damages, repairs or inefficiency resulting from faulty installation or application of the Product.

This 1-year Standard and 15-year Limited Warranty covers only parts as provided herein. DuraVent's entire liability is limited to the purchase price of this Product. In no case shall DuraVent be responsible for materials, components or construction that are not manufactured or supplied by DuraVent or for the labor necessary to install, repair or remove such materials, components or construction. All replacement or repair components will be shipped F.O.B. from the DuraVent manufacturing facility.

Limitation on Liability

It is expressly agreed and understood that the sole obligation of DuraVent and the purchaser's exclusive remedy under this warranty, under any other warranty, expressed or implied, or in contract, tort or otherwise, shall be limited to replacement, repair, or refund, as specified herein. In no event shall DuraVent be liable for any incidental or consequential damages caused by defects in the Product, whether such damage occurs or is discovered before or after replacement or repair, and whether such damage is caused by DuraVent negligence. DuraVent makes no expressed warranties except as stated in this 1-year Standard and 15-year Limited Warranty. The duration of any implied warranty is limited to the duration of this expressed warranty. No one is authorized to change this 1-year Standard and 15-year Limited Warranty or to create for DuraVent any other obligation or liability in connection with the Product. Some states and provinces do not allow the exclusion or limitation of incidental or consequential damages, so the above limitations or exclusions may not apply to you. The provisions of this 1-year Standard and 15-year Limited Warranty are in addition to and not a modification of or subtraction from any statutory warranties and other rights and remedies provided by law.

Investigation of Claims Against Warranty

DuraVent reserves the right to investigate any and all claims against this 1-year Standard and 15-year Limited Warranty and to decide, in its sole discretion, upon the method of settlement. DuraVent shall in no event be responsible for any warranty work done by a contractor who is not approved without first obtaining DuraVent's prior written consent.

For the most up-to-date installation instructions, see duravent.com

REV 4.1.2013

Manufactured in Laval, Quebec

LIMITED LIFETIME WARRANTY**Industrial and Commercial Chimney and Venting Products Limited Lifetime Warranty**

This DuraVent Limited Lifetime Warranty warrants your DuraStack® – DIS stainless steel multi-fuel double-wall insulated chimney system (Product) in a grease duct application to be free from defects in material and workmanship at the time of manufacture when properly connected to and included as a part of a code-compliant commercial kitchen ventilation system for cooking appliances. This Limited Lifetime Warranty includes all components and fittings. After installation, if covered components manufactured by DuraVent are found to be defective in materials or workmanship during the Limited Lifetime Warranty period and while the Product remains at the site of the original installation, DuraVent will replace the covered components. DuraVent reserves the right to replace covered components with an equivalent product and the replacement must be carried out in accordance with DuraVent recommendations. If replacement is not commercially practical, DuraVent will, at its option, refund the purchase price or wholesale price of the DuraVent Product, whichever is applicable. Labor or freight costs to remove or replace DuraVent components are not included. THERE ARE EXCLUSIONS AND LIMITATIONS to the Limited Lifetime Warranty as described herein.

Coverage Commencement Date

Warranty coverage begins on the date of shipment from DuraVent.

Exclusions and Limitations

This Limited Lifetime Warranty applies only if the Product is installed in the United States or Canada and only if used for the application for which it was designed and intended. The Product must be installed and maintained in accordance with the design, installation and maintenance instructions for the Product and in compliance with all applicable installation and building codes and high-quality, industry accepted trade practices.

This warranty is non-transferable and extends to the original owner only. The Product must be purchased through an DuraVent Agent/Representative and proof of purchase must be provided.

Components and fittings (excludes labor):

Year 1-10 – Replacement of all components and fittings.

Year 11-15 – Replacement at 75% off of the prevailing list price in effect at the time of replacement (25% of the retail list price paid by the consumer).

Year 16+ – Replacement at 50% off of the prevailing list price in effect at the time of replacement (50% of the retail list price paid by the consumer).

DuraVent will not be responsible for: (a) damages caused by normal wear and tear, corrosion from salt air, accident, riot, fire, flood, high wind or acts of God; (b) damages caused by abuse, negligence, misuse, or unauthorized alteration or repair of the Product affecting its stability or performance; (c) damage resulting from failure to reasonably clean, care for or maintain products in accordance with the printed design, installation and maintenance instructions for the Product; (d) damages caused by failing to provide proper maintenance and service in accordance with the design, installation and maintenance instructions for the Product, including damage to the finish of the Product caused by the use of improper solvents/chemicals or improper cleaning methods; (e) damages, repairs or inefficiency resulting from faulty installation or application of the Product; (e) replacement of system sealants as a result of improper installation or a system grease fire.

This Limited Lifetime Warranty covers only parts as provided herein. DuraVent's entire liability is limited to the purchase price of this Product. In no case shall DuraVent be responsible for materials, components or construction which are not manufactured or supplied by DuraVent or for the labor necessary to install, repair or remove such materials, components or construction. All replacement or repair components will be shipped F.O.B. from the DuraVent manufacturing facility.

Limitation on Liability

It is expressly agreed and understood that the sole obligation of DuraVent and the purchaser's exclusive remedy under this warranty, under any other warranty, expressed or implied, or in contract, tort or otherwise, shall be limited to replacement, repair, or refund, as specified herein.

In no event shall DuraVent be liable for any incidental or consequential damages caused by defects in the Product, whether such damage occurs or is discovered before or after replacement or repair, and whether such damage is caused by DuraVent negligence. DuraVent makes no expressed warranties except as stated in this Limited Lifetime Warranty. The duration of any implied warranty is limited to the duration of this expressed warranty. No one is authorized to change this Limited Lifetime Warranty or to create for DuraVent any other obligation or liability in connection with the Product. Some states and provinces do not allow the exclusion or limitation of incidental or consequential damages, so the above limitations or exclusions may not apply to you. The provisions of this Limited Lifetime Warranty are in addition to and not a modification of or subtraction from any statutory warranties and other rights and remedies provided by law.

Investigation of Claims Against Warranty

DuraVent reserves the right to investigate any and all claims against this Limited Lifetime Warranty and to decide, in its sole discretion, upon the method of settlement. DuraVent shall in no event be responsible for any warranty work done by a contractor that is not approved without first obtaining DuraVent's prior written consent.

For the most up-to-date installation instructions, see duravent.com

REV 4.1.2013

Manufactured in Laval, Quebec

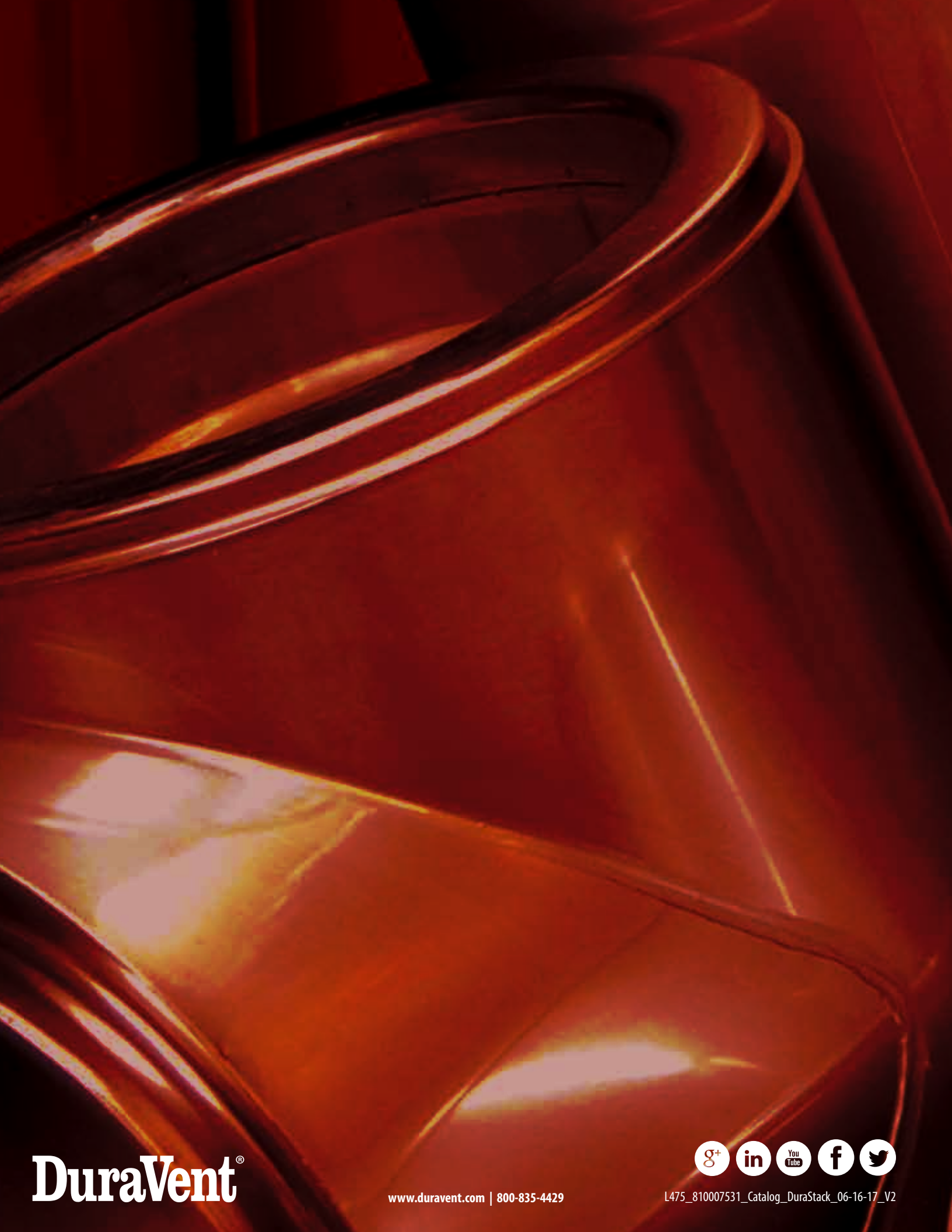

DuraVent[®]

www.duravent.com | 800-835-4429



L475_810007531_Catalog_DuraStack_06-16-17_V2